



rammm

Follow the rainbow

Level 1

- 10 Case Histories
- 11 Finders Keepers?
- 12 World Cultures
- 13 World Cultures
- 14 Egyptian Tomb
- 15 Ancient Worlds
- 16 Sladen's Study
- 17 In Fine Feather
- 18 Fly on the Wall
- 19 Courtyard
- 20 Exhibition
- 21 Exhibition
- 22 Exhibition
- 23 Meeting Room
- 24 Viewing Gallery
- 25 Roman Wall

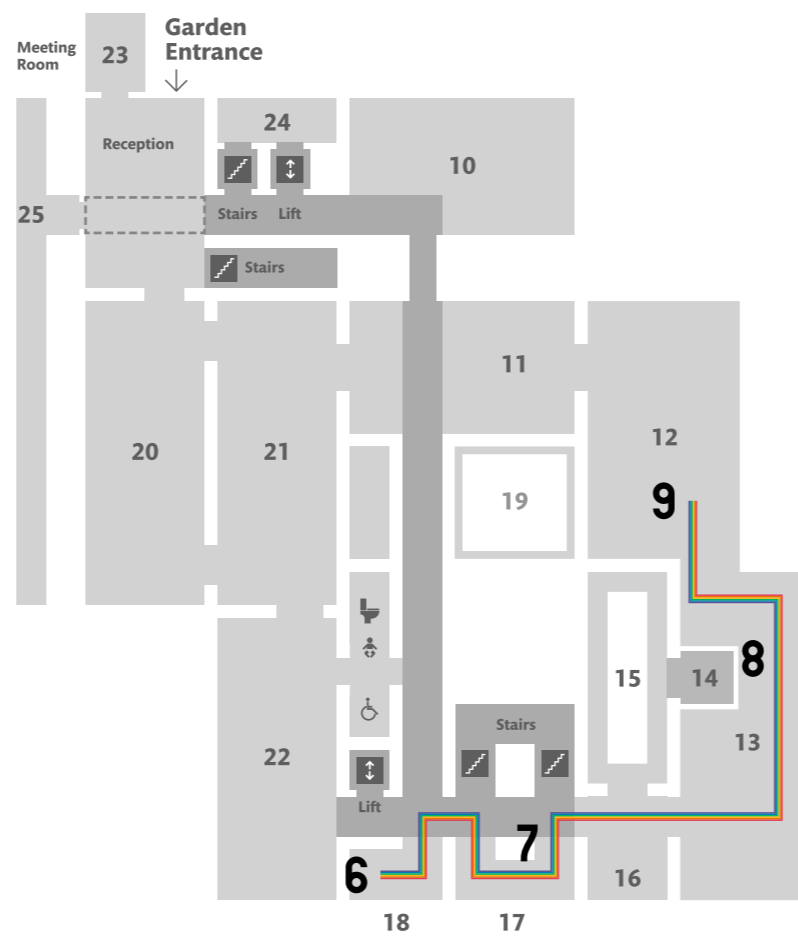

Facilities on this floor

- Toilets Near 22
- Baby change Near 22
- Accessible toilet Near 22
- Wifi Throughout building

Welcome to the Rainbow Trail, which explores gender and sexual diversity across time, place and culture.

- ▶ Discover fascinating stories through a range of lesbian, gay, bisexual, transgender, queer, intersex and asexual-related (LGBTQIA) objects
- ▶ Celebrate the lives of LGBTQIA+ people and their history
- ▶ View the collections from a different perspective

Ground Floor

- 1 Courtyard
- 2 Down to Earth
- 3 Making History
- 4 Making History
- 5 The Shop at RAMM
- 6 Behind the Scenes
- 7 More in Store
- 8 Viewpoint
- 9A Meeting Rooms
- 9B Meeting Rooms

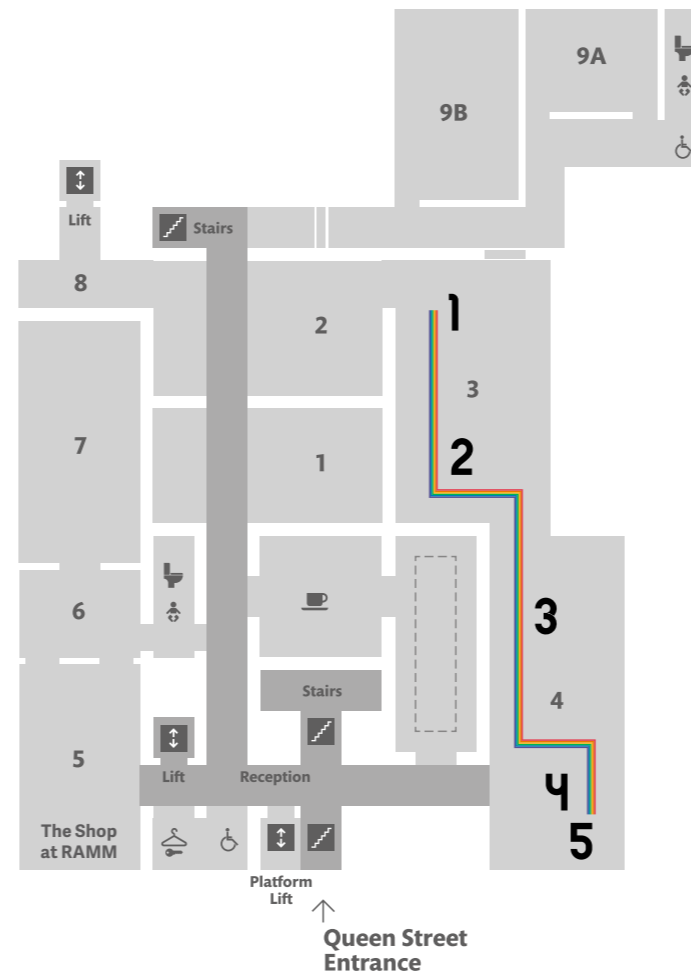

Facilities on this floor

- Toilets Near 6
- Baby change Near 6
- Cafe Near 1
- Lockers Near 5
- Accessible toilet Near 5
- Wifi Throughout building



Begin on the Ground Floor
Gallery 3 Making History

Can you spot the ceramic figurine of a headless person nursing two children? It shows a fertility goddess, the Dea Nutrix.

What does this figurine represent? What purpose did it serve?

Such figures have been interpreted as remnants of pre-Greek and pre-Roman matriarchal societies that were focused on women and that were erased by later patriarchal societies structured around men. Jane Ellen Harrison (1850-1928), a British classicist and feminist who had several relationships with other women, developed this argument.

What would history look like if it were written from the perspective of cisgender and transgender women?



Mother goddess figurine. About 150, Exeter

Try this trail on your smartphone:
<http://m.rammtimetrail.org.uk/RainbowTrail/>



Free wifi
Just connect to RAMMuseum and follow the login instructions



This trail was designed by Natalie McGrath and Prof Jana Funke (University of Exeter) together with young LGBTQIA+ people from the X-Plore Youth Group and Exeter College's LGBTQ+ Society.



**Gallery 3
Making History**



Formal gown, England. About 1760-70.

Look for an elaborate formal gown.

In Ryan Murphy's television show *Pose* (2018), a group of friends steal royal costumes from a museum to use in their drag acts. The show depicts the New York ball scene of the 1980s, a flourishing subculture created by Black and Latinx trans and queer people.

Legendary black queens like Pepper LaBeija (1948-2003) or Venus Xtravaganza (1965-1988) were famous for their grand costumes and often drew inspiration from history to craft their own performances.

Which objects from the museum would you use in your own drag show?



**Gallery 4
Making History**



Longcase clocks, England. About 1750-60.

Explore the gallery until you see three large clocks.

Time along with same-sex desire, art and beauty are key themes in *The Picture of Dorian Gray* (1890), a novel by Irish author Oscar Wilde (1854-1900). Dorian does not age and enjoys seemingly eternal youth.

How have age and ageing affected your identity?

In 1895, Wilde was convicted of gross indecency with men, leading to two years of hard labour, which sadly destroyed his health. His work lives on and has inspired generations of writers, theatre, film and TV makers.

Do you know when male homosexuality was decriminalised in the UK?



**Gallery 4
Making History**



Second World War Anderson shelter, Exeter. Donated in the 1990s.

Stop at the air raid shelter.

The Second World War and the Blitz are central to *The Night Watch* (2006), a historical novel by English author Sarah Waters (born in 1966). Set in the 1940s, it charts the lives of three lesbian characters, Kay, Helen and Julia. During the night watch, liaisons are made and love is forged amidst the sounds of bombs falling.

Why do many lesbian novelists write historical fiction?

An earlier novel, *The Well of Loneliness* (1928), by English writer Radclyffe Hall (1880-1943), similarly describes how queer people find love at the front during the First World War.



**Gallery 4
Making History**



Tailfin of an incendiary bomb. 4 May 1942, Exeter.

Explore other objects related to the Second World War.

Mathematician and computer scientist Alan Turing (1912-1954) played a key role in developing the Enigma machine during the Second World War. His work was pivotal in cracking the German's codes, thus enabling the Allies to win the war. In 1952, Turing was prosecuted for homosexual acts and underwent chemical castration, which led to his premature death. He was awarded a posthumous royal pardon in 2013.

Do you think it is enough for Turing to be "pardoned"?

How would our understanding of history change if we knew more about the contributions of LGBTQIA+ people?



Walk up the main staircase (by the pink wall) or take the lift to the First Floor

**Gallery 18
Fly on the Wall**

Blue morpho butterfly, Peru.

Have a look at the beautiful display of butterflies.

Why are butterflies often used as a symbol by the LGBTQIA+ community?

In 1915, German-born American biologist Richard Goldschmidt (1878-1958) coined the term intersex. He had discovered that moths (*Lymantria dispar*) could be bred to combine typically male and female physical characteristics. Nowadays, the term intersex is used to refer to people who are born with sex characteristics (such as chromosomes or hormonal structures) that cannot strictly be classified as male or female. Such variations of sex characteristics occur naturally and, in most cases, do not require medical intervention.

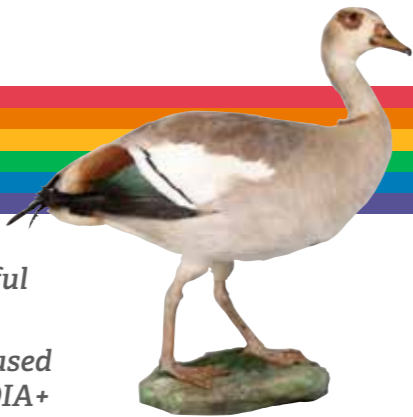

Now go to the gallery next door

**Gallery 17
In Fine Feather**

Egyptian goose, originally from Africa.

Find the Egyptian goose.

The protagonist of *Orlando* (1928), a novel by English author Virginia Woolf (1882-1941), is assigned male at birth in the 16th century. Aged about 30, they magically transition physically and live as a woman for several centuries. Orlando repeatedly chases after a mysterious goose without capturing it.

What can Orlando teach us about gender?

The book is a playful biography of Woolf's lover, the writer Vita Sackville-West (1892-1962). Sackville-West was bisexual and identified as masculine and feminine. After reading *Orlando*, Sackville-West wondered: "What does the goose stand for? Fame? Love? Death? Marriage?"

What is Orlando chasing?



Walk through Sladen's Study into Gallery 13

World Cultures

Effigy bottle, early 20th Century, New Mexico.

Look for an object shaped like a badger with a lizard on its back.

A Zuni artist made this vessel. The Zuni people have lived in the American Southwest for thousands of years.

We'wha (1849-1896) was a famous Zuni artist whose pottery was celebrated across America. We'wha was Lhamana, the Zuni term for individuals who are assigned male at birth and identify (at least partly) as female. Lhamana individuals are respected in Zuni society.

Nowadays, the term Two-Spirit is used to describe gender diverse identities specific to some Native American communities.

Can you find other objects by Zuni artists nearby?



Walk through to Gallery 12

World Cultures

Shiva and Parvati, Maharashtra, central India.

Look for the figurine of Shiva and Parvati in the display case opposite the green robe

Shiva and Parvati are two married Hindu deities. They are sometimes depicted as a single god, Ardhanari, who is half-male and half-female.

Ardhanari has special significance for Indian Hijra communities. Hijras are often described as transgender, although their identities have no direct match within Western ideas of sex and gender. Hijra communities were criminalised under British colonial rule.

How has colonial rule negatively impacted gender and sexually diverse people around the world?



Is there a RAMM object that you think tells an interesting LGBTQIA+ story?

Please share your ideas with us using #QueeringRAMM